

Clear Cup

Removal & Replacement

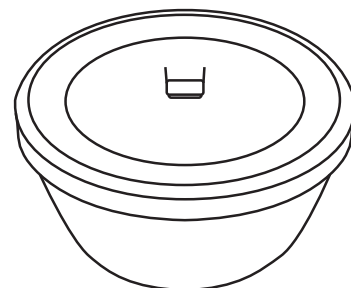

Removal

- Align the notch on the left hand side arm and disengage by squeezing the cup and gently pulling the arm outwards. Then rotate the cup to free it from the other arm.

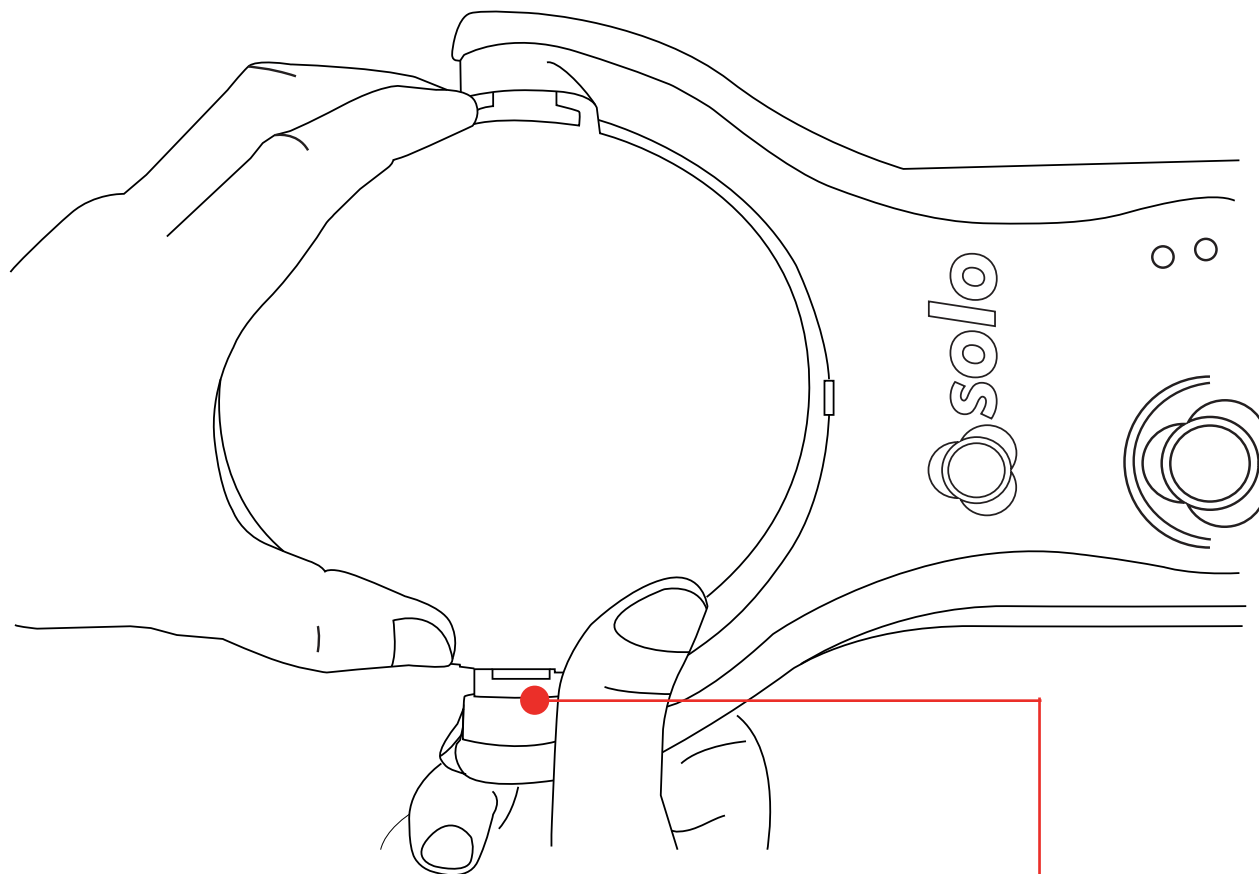

Replacement

- Engage the cup with the notch on the left hand arm and rotate the cup to engage with the notch on the right hand side.
- Ensure the cup vent is the same side as the back of the unit.

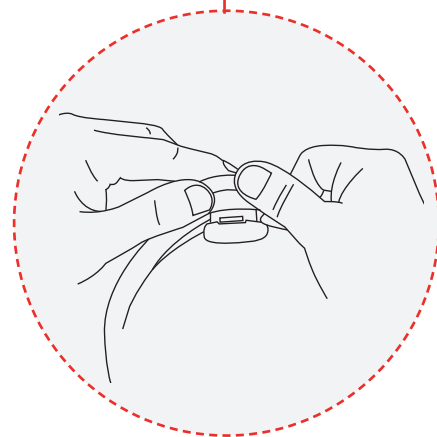

Membrane Removal & Replacement

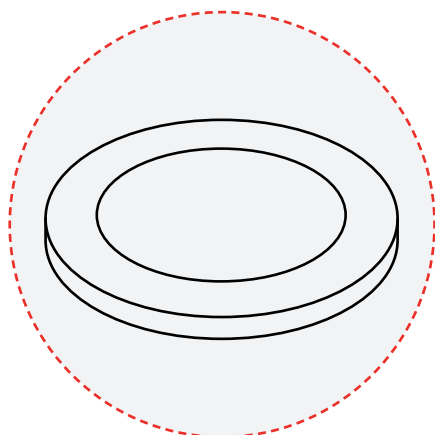
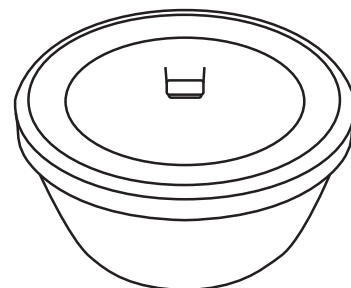

Removal

- Ease the membrane off the clear cup gently

Replacement

- Stretch the replacement membrane over the clear cup.

