



C-CURE 9000 Solutions - BEST SHELTER™ Lockdown



Key Benefits

- Wireless responsive lockdown solution that can be configured to adapt to your building
- Integrates with C-CURE 9000 through relay input/output connection to an iSTAR Controller
- Lock down a single door, a set of doors or an entire building
- Connect to an alarm panel to notify first responders
- Ideal for new buildings as well as retrofitting existing facilities' cylindrical locks

Securing Safe Spaces

C-CURE 9000 integrates with BEST SHELTER™ Lockdown, providing a responsive lockdown solution that can be configured to adapt to your building and security protocol. This solution is ideal for and specifically designed as a lockdown product for use in education and commercial environments looking to protect students and employees.

How SHELTER Works

If an emergency happens, an authorized user holds down the fob button transmitting a lockdown request to the repeater. The repeater when connected to an iSTAR Controller can be configured to trigger an event in C-CURE 9000 as well as locking down the pre-configured doors. The integration is easy to deploy and is done through relays in the repeater tied to inputs and outputs on the iSTAR Ultra controller. This allows for a comprehensive, safe, responsive and configurable lockdown solution.

Cloud-Based Portal

Under an affordable annual subscription, SHELTER includes a web-based portal which allows administrators to configure the system from any web browser. In addition, the software includes self-diagnostic test reports, equipment battery life feedback and the ability to send email/text notifications for lockdown status changes.





Fob
The BEST fob allows you to quickly and easily lock down your building via the SHELTER 900 MHz secure wireless network. Fobs can be assigned to lock down a single door, a set of doors or an entire building.

9KX Cylindrical Lock
The BHMA Grade 1 lock functions on a 900 MHz secure wireless network. After receiving a lockdown command from the system, the 9KX transitions from standard classroom function to storeroom function. It is also equipped with visual and audio alarms to alert users that it is in lockdown mode.

Gateway and Repeater
At the core of the SHELTER system is a gateway that sends signals to each door lock to initiate lockdown. With a 400-foot range, the gateway can be paired with up to eight repeaters to extend the signal range throughout a building. And with assistance from your integration resource, the SHELTER repeater can be connected to existing C-CURE 9000 access control systems.

Basic System Diagram

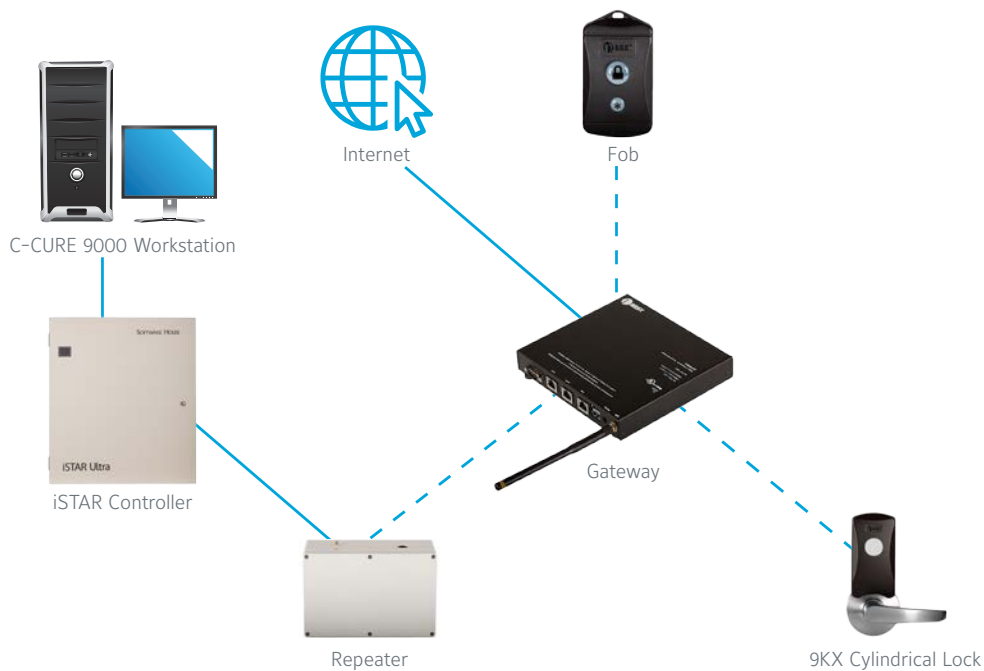

Specifications

SHELTER Fob	
Dimensions	1.7 x 3.1 in.
Weight	1.4 oz.
Maximum Range	200 ft. indoors (typical)
Battery	Standard 3V CR2450 battery; Up to 3 year battery life
Code Compliance	FCC Part 15 B&C
SHELTER 9KX	
Backset	2 3/4" standard, 3 3/4" and 5"
Chassis	Critical latch and chassis components are brass or corrosion-treated steel; 2 1/16" diameter to fit 2 1/8" hole in door (Conforms to ANSI A115.2)
Latch	Solid brass 9/16" throw; Front 2 1/4" x 1 1/8" beveled
Wireless Communication	900 MHz; Range of 400 ft. indoors; 1,200 ft. line of site (typical)
Batteries/Warnings	4 AA batteries (included); Up to 3-year battery life; Low battery warning at lock
Code Compliance	UL10C-3 Hour; ANSI/BHMA A156.2 Grade 1, ANSI/BHMA A156.25 and ANSI/BHMA A156.5; NFPA101 Life Safety Code and IBC Compliant; FCC Part 15, B; and UL1034 Listed
SHELTER™ Gateway	
Size	6.7 x 6.3 x 1.1 in.
Wireless Communications	900 MHz; Range of 400 ft. indoors; 1,200 ft. line of site (typical)
Power Supply	12VDC; Wall wart power supply provided; Battery backup recommended
Code Compliance	UL 60950, FCC Part 15 Compliant
SHELTER™ Repeater	
Size	9.4 x 6.3 x 3.3 in.
Wireless Communications	900MHz; Range of 400 ft. indoors; 1,200 ft. line of site (typical)
Power Supply	12/24V DC power; Power supply not included; Battery backup recommended
Inputs	2 dry contact switch inputs; Configurable to initiate or cancel lockdown
Outputs	2 form C relay outputs, 24V/1A rated
Code Compliance	UL 60950

About Johnson Controls

Johnson Controls is a global diversified technology and multi-industrial leader serving a wide range of customers in more than 150 countries. Our 120,000 employees create intelligent buildings, efficient energy solutions, integrated infrastructure and next generation transportation systems that work seamlessly together to deliver on the promise of smart cities and communities. Our commitment to sustainability dates back to our roots in 1885, with the invention of the first electric room thermostat.